

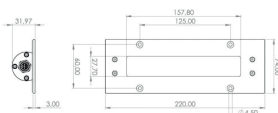

Recessed luminaire TUBELED_40 II integrated, 220 mm x 74 mm x 3 mm

Item number: 151010-01
EAN: 4260556623948

Order number:	151010-01
Model:	TUBELED_40 II Integrated
Type:	LED recessed luminaire
Illuminant:	SMD LED
Power consumption:	~8 W
Lamp luminous flux:	1078 lm
Lamp luminous efficiency:	131 lm/W
Light distribution:	Light Forming Technology
Light colour:	daylight white (5200 - 5700K)
Connected load:	24V DC \pm 10%
Connection (connector):	M12 A-type encoded
Degree of protection:	IP67/IP69K
Class of protection:	III
Glare-free	diffused safety glass
Beam angle (optics):	100°
Operating temperature:	-30... +60 °C
Colour rendering (Ra):	> 85
Lamps lifetime:	> 60,000 h
Housing material:	aluminium
Cover material:	Safety glass, 4 mm
Height [B] x Width [C]:	32 mm x 74 mm, Cover plate 3 mm externally
Length [A]:	220 mm
Weight (net):	450 g
Gross weight:	700 g
Risk group (DIN EN 62471):	free group
Marking:	CE, UKCA, ETL Listed
Dimmable:	via optional accessory
Made in:	Germany



TUBELED_40 II Integrated 151010-01

Lamps lifetime in operation hours (L80/B10)