

## LED-Industrieleuchte

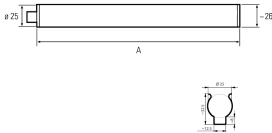
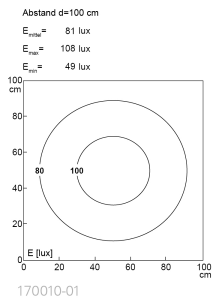

<b>Product-Nr.</b>	117010-01
<b>EAN:</b>	4260556621555
<b>Model:</b>	INROLED_25
<b>Order number:</b>	117010-01
<b>Model:</b>	INROLED_25
<b>Type:</b>	LED tube luminaire
<b>Illuminant:</b>	SMD LED
<b>Power consumption:</b>	~4,5 W
<b>Lamp luminous flux:</b>	583 lm
<b>Lamp luminous efficiency:</b>	129 lm/W
<b>Light distribution:</b>	direct
<b>Light colour:</b>	daylight white (5200 - 5700K)
<b>Connected load:</b>	24V DC $\pm$ 10%
<b>Connection (connector):</b>	M12 connector A-type encoded
<b>Degree of protection:</b>	IP69K
<b>Class of protection:</b>	III
<b>Beam angle (optics):</b>	100°
<b>Operating temperature:</b>	-10... +50 °C (14... 122 °F)
<b>Colour rendering (Ra):</b>	> 80
<b>Lamps lifetime:</b>	> 60.000 h (L80/B10)
<b>Cover material:</b>	polycarbonate, shatterproof
<b>Height [B] x Width [C]:</b>	Ø 25 mm (Ø 0,98")
<b>Length [A]:</b>	348 mm (13,70")
<b>Weight (net):</b>	150 g (~5 oz)
<b>Gross weight:</b>	300 g (~11 oz)
<b>Risk group (DIN EN 62471):</b>	free group
<b>Markings:</b>	CE, UKCA, ETL Listed (5003529)
<b>Dimmable:</b>	via optional accessory
<b>Mounting accessories:</b>	incl. luminaire holders
<b>Made in:</b>	Germany
<b>Feature:</b>	food-safe, resistant to acids and alkalis (case-by-case testing before)