

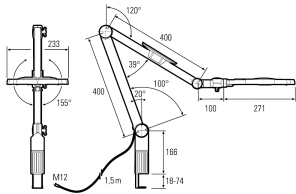

Abstand $d = 15 \text{ cm}$
 $E_{\text{max}} = 7000 \text{ lx}$



LED-Arbeitsplatzleuchte

Product-Nr.	120810-12
EAN:	4260556620244
Model:	LENSLED II Gelenkarm
Order number:	120810-12
Model:	LENSLED II Gelenkarm
Type:	LED adjustable arm light
Magnifying lens:	Biconvex Ø 160 mm + bifocal Ø 31.5 mm
Illuminant:	SMD LED
Power consumption:	~15 W
Lamp luminous flux:	1570 lm
Lamp luminous efficiency:	ca. 105 lm/W
Light distribution:	direct
Light colour:	daylight white (5200 - 5700K)
Scope of delivery:	luminaire and additional luminaire holder 210200-11
Connected load:	24V DC \pm 10%
Power supply:	included external PSU 100-240V AC
Connection (connector):	M12 A-type encoded
Connected load PSU:	100-240V AC
Connection PSU:	EURO plug to M12 connector
Degree of protection:	IP40
Class of protection:	III
Glare control:	opal white
Beam angle (optics):	120°
Operating temperature:	-10... +40 °C (14... 104 °F)
Colour rendering (Ra):	>90
Lamps lifetime:	> 60.000 h (L80/B10)
Magnifier material:	Glass
Housing material:	aluminium / plastics
Cover material:	plastic soft
Length articulated arms:	2x 400 mm
Weight (net):	2700 g (~95 oz)
Gross weight:	4400 g (~155 oz)
Risk group (DIN EN 62471):	free group
Markings:	CE, UKCA
Dimmable:	internal dimmer with memory function
Mounting accessories:	included table clamp
Made in:	Germany
Feature:	glass magnifier + bifokal, illuminated, 3,5 dpt., Ø160 mm (6,30"), bifokal 31,5 mm (1,24"), extremely scratchproof